

# BEAU RIVAGE: PHASE 2 - RELEASE 2 ERF - SIZE ERF - SIZE

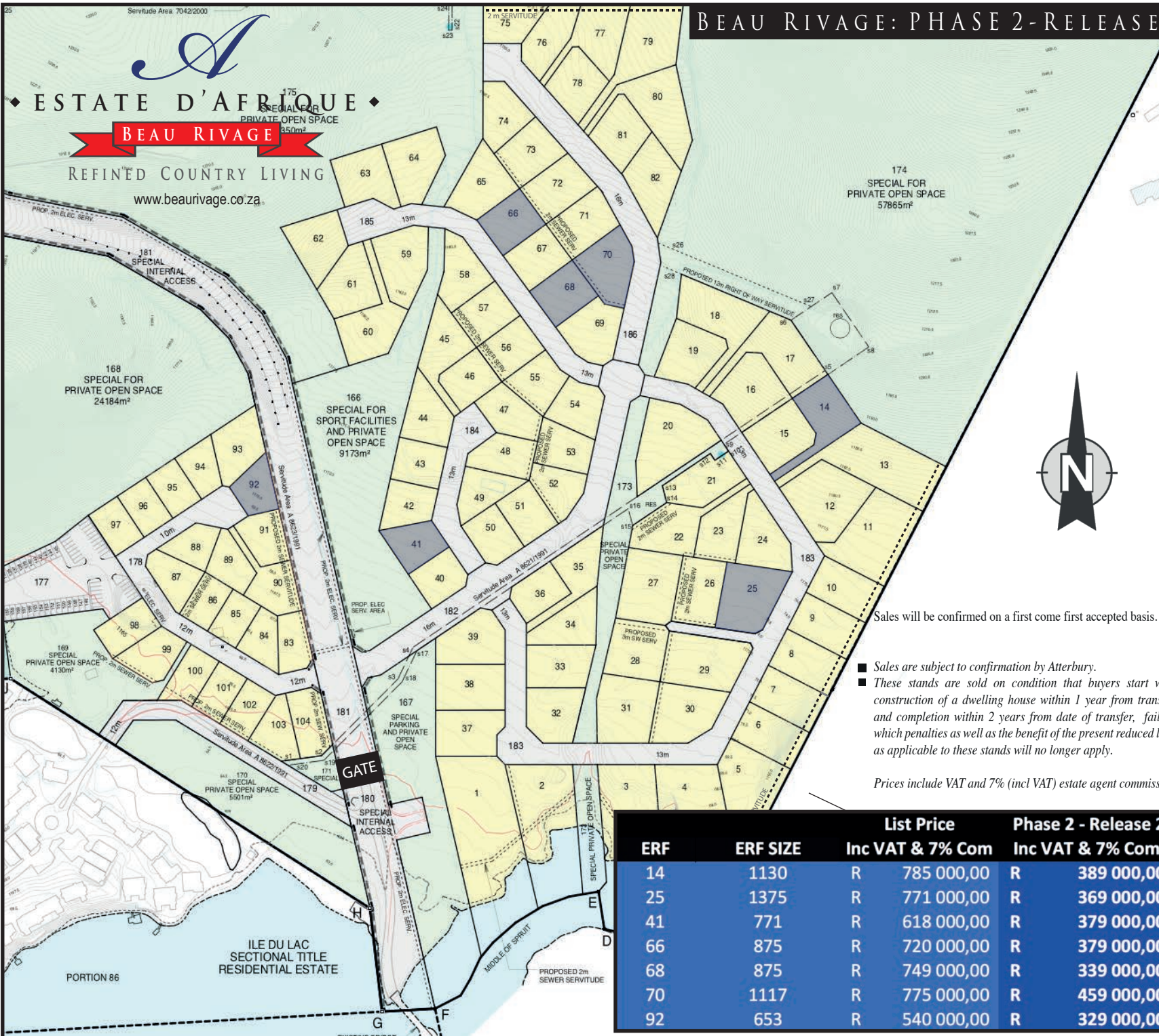

**ESTATE D'AFRIQUE**  
**BEAU RIVAGE**  
 REFINED COUNTRY LIVING  
 www.beaurivage.co.za

1 - 4443m <sup>2</sup>	53 - 851m <sup>2</sup>
2 - 2812m <sup>2</sup>	54 - 855m <sup>2</sup>
3 - 3794m <sup>2</sup>	55 - 821m <sup>2</sup>
4 - 4222m <sup>2</sup>	56 - 858m <sup>2</sup>
5 - 1814m <sup>2</sup>	57 - 858m <sup>2</sup>
6 - 1030m <sup>2</sup>	58 - 959m <sup>2</sup>
7 - 1029m <sup>2</sup>	59 - 1227m <sup>2</sup>
8 - 1029m <sup>2</sup>	60 - 1295m <sup>2</sup>
9 - 1029m <sup>2</sup>	61 - 1102m <sup>2</sup>
10 - 1030m <sup>2</sup>	62 - 1075m <sup>2</sup>
11 - 1935m <sup>2</sup>	63 - 1080m <sup>2</sup>
12 - 1681m <sup>2</sup>	64 - 1189m <sup>2</sup>
13 - 2195m <sup>2</sup>	65 - 1113m <sup>2</sup>
14 - 1130m <sup>2</sup>	66 - 875m <sup>2</sup>
15 - 1133m <sup>2</sup>	67 - 875m <sup>2</sup>
16 - 1319m <sup>2</sup>	68 - 875m <sup>2</sup>
17 - 1499m <sup>2</sup>	69 - 1069m <sup>2</sup>
18 - 1508m <sup>2</sup>	70 - 1117m <sup>2</sup>
19 - 1116m <sup>2</sup>	71 - 1024m <sup>2</sup>
20 - 1738m <sup>2</sup>	72 - 1019m <sup>2</sup>
21 - 1038m <sup>2</sup>	73 - 981m <sup>2</sup>
22 - 1206m <sup>2</sup>	74 - 891m <sup>2</sup>
23 - 954m <sup>2</sup>	75 - 883m <sup>2</sup>
24 - 1058m <sup>2</sup>	76 - 1004m <sup>2</sup>
25 - 1375m <sup>2</sup>	77 - 1290m <sup>2</sup>
26 - 1097m <sup>2</sup>	78 - 990m <sup>2</sup>
27 - 1460m <sup>2</sup>	79 - 1750m <sup>2</sup>
28 - 1184m <sup>2</sup>	80 - 1571m <sup>2</sup>
29 - 1512m <sup>2</sup>	81 - 987m <sup>2</sup>
30 - 1304m <sup>2</sup>	82 - 1175m <sup>2</sup>
31 - 1392m <sup>2</sup>	83 - 648m <sup>2</sup>
32 - 1032m <sup>2</sup>	84 - 634m <sup>2</sup>
33 - 1021m <sup>2</sup>	85 - 600m <sup>2</sup>
34 - 915m <sup>2</sup>	86 - 601m <sup>2</sup>
35 - 953m <sup>2</sup>	87 - 728m <sup>2</sup>
36 - 761m <sup>2</sup>	88 - 629m <sup>2</sup>
37 - 1109m <sup>2</sup>	89 - 685m <sup>2</sup>
38 - 1186m <sup>2</sup>	90 - 901m <sup>2</sup>
39 - 1140m <sup>2</sup>	91 - 766m <sup>2</sup>
40 - 752m <sup>2</sup>	92 - 653m <sup>2</sup>
41 - 771m <sup>2</sup>	93 - 982m <sup>2</sup>
42 - 776m <sup>2</sup>	94 - 622m <sup>2</sup>
43 - 780m <sup>2</sup>	95 - 630m <sup>2</sup>
44 - 935m <sup>2</sup>	96 - 630m <sup>2</sup>
45 - 1066m <sup>2</sup>	97 - 630m <sup>2</sup>
46 - 801m <sup>2</sup>	98 - 748m <sup>2</sup>
47 - 865m <sup>2</sup>	99 - 818m <sup>2</sup>
48 - 842m <sup>2</sup>	100 - 694m <sup>2</sup>
49 - 782m <sup>2</sup>	101 - 646m <sup>2</sup>
50 - 788m <sup>2</sup>	102 - 646m <sup>2</sup>
51 - 801m <sup>2</sup>	103 - 750m <sup>2</sup>
52 - 774m <sup>2</sup>	104 - 836m <sup>2</sup>

Sales will be confirmed on a first come first accepted basis.

- Sales are subject to confirmation by Atterbury.
- These stands are sold on condition that buyers start with construction of a dwelling house within 1 year from transfer and completion within 2 years from date of transfer, failing which penalties as well as the benefit of the present reduced levy as applicable to these stands will no longer apply.

Prices include VAT and 7% (incl VAT) estate agent commission.

ERF	ERF SIZE	List Price	
		Inc VAT & 7% Com	Phase 2 - Release 2 Inc VAT & 7% Com
14	1130	R 785 000,00	R 389 000,00
25	1375	R 771 000,00	R 369 000,00
41	771	R 618 000,00	R 379 000,00
66	875	R 720 000,00	R 379 000,00
68	875	R 749 000,00	R 339 000,00
70	1117	R 775 000,00	R 459 000,00
92	653	R 540 000,00	R 329 000,00